

PARTING VIEW

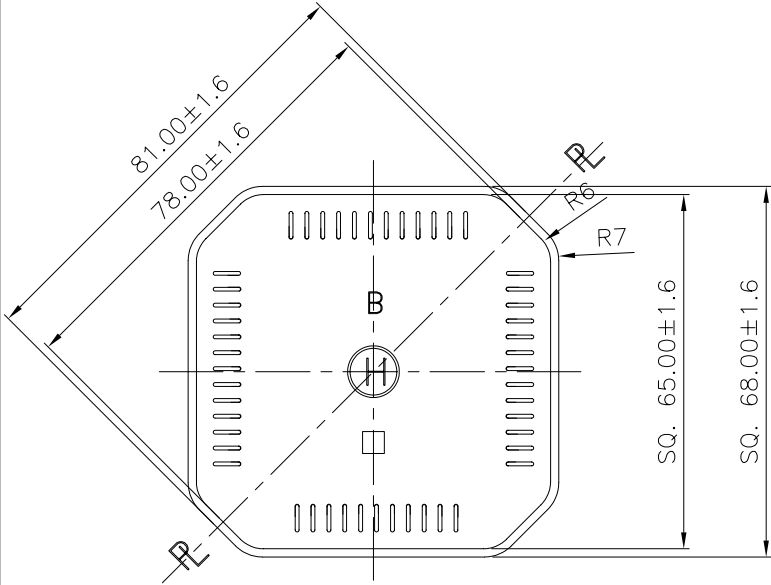

ALL DIMENSIONS ARE IN MILLIMETERS

| | | | | | | | | | | | | | |
|-------------------------------------|--------------|----------------------|--------------------|----------|-------|--------------------------|------|-----------|-------|---|------|--|--|
| PROCESS | PRESS & BLOW | | | | | | | | | SPECIFICATION AGREEMENT ARE BASED ON TOLERANCED DIMENSIONS ONLY DO NOT SCALE DRAWING COPYRIGHT RESERVED. NOT TO BE COPIED IN WHOLE OR PART WITHOUT WRITTEN PERMISSION | | | |
| MINIMUM THROUGH BORE | | | | | | | | | | EKAM GLOBAL PTY LTD | | | |
| FILL POINT VERIFIED | NO | | | | | | | | | | | | |
| TILT ANGLE | - | No. | REV. No. | REVISION | | | DATE | CHK | DRC | TITLE: 500 GMS. SQUARE JAR S. L. WT. (G.M.) | | | |
| MAXIMUM DEPTH OF STANDARD ENGRAVING | 0.4 | FILL-POINT | -- ml ± -- ml | | | CUSTOMER: M/s. | | | | | | | |
| MAX. GAS VOLUMES | - | BRIMFUL CAP. | 400 ml ± 7.0 ml | | | CHECKED: | | APPROVED: | | | | | |
| REF DRG No. | CD-4727 | WEIGHT | 210 Gms. ± 15 Gms. | | | DRAWN: Rajesh 13.02.2006 | | COLOUR | FLINT | A3 | | | |
| MOULD EQUIPMENT ORDERED BY | FINISH | 63 MM. LUG WITH BEAD | | | SCALE | | 1:1 | | | DRAWING No. 42737 | REV. | | |
| PLANT | B | SURFACE TREATMENT | NO | | | C.C. NO. 42737 | | | | | | | |